



Fisher Hamilton®

Introducing the SafeAire® HORIZON® FullView Ventilated Workstation System

Enhance Visibility

The Horizon Workstation System is an integrated family of glass-sided fume hoods for safety-conscious environments, facilitating total visibility of the entire laboratory from any location. Visibility of the entire laboratory means instant recognition of problem situations.



Two Horizon Fume Hoods ready to be placed side-by-side. A unique joining system eliminates costly double end panels between hoods and increases work area width.



Two Horizon Fume Hoods placed side-by-side sharing a common end.

Modular system provides economical multiple workstations

Choose from single-faced wall style or a double-faced module in a variety of widths. Multiple workstations are designed to be ganged together, side-by-side.

Save money when multiple side-by-side workstations are required because a common end panel is utilized between two fume hood superstructures.

Exclusive AutoSash positioning system

A sash opening height of 18" has become an industry standard for two reasons. First, the reduced 18" opening during fume hood operation can reduce the exhaust air requirement by about 50% for significant energy savings. Second, the upper 12" of fume hood face opening is covered by sash glass during fume hood operation, providing face and upper body protection for the operator. The sash automatically closes to the 18" or lower operating height.

SafeAire Horizon Benefits:

- ◆ **Full visibility.** Glass panels on side and back enhance the ability to spot hazardous situations.
- ◆ **Complete product offering.** Available in four, five and six foot widths in both single and double sided configurations.
- ◆ **Verifiable performance.** The Horizon meets all ASHRAE 110-95 Standards.
- ◆ **State-of-the-art air flow.** Perimeter exhaust slots provide uniform air flow thru hood interior.
- ◆ **Lower operating costs.** Low hood static pressure equals lower exhaust system purchase and lifetime operation costs.
- ◆ **Ships disassembled for easier handling.** Ships knocked-down for reduced freight costs and accessibility to existing facilities through any doorway.
- ◆ **Improved access to hood interior.** A patented flush sill airfoil eliminates the vertical obstruction that is present with traditional raised sill style airfoils.
- ◆ **Secondary spill containment.** An integral spill trough along front edge of work surface provides additional protection from chemical spills.
- ◆ **Reduced maintenance.** Remote control service valves are located in base cabinets – no dismantling of fume hood to service valves.
- ◆ **More usable work surface.** Services are mounted in an isolated vertical service drop compartment in the fume hood interior.
- ◆ **More interior work area.** The airfoil front with narrow post design provides more usable interior width.
- ◆ **Lifetime durability.** The sash counterbalance system is life-tested to 100,000 cycles.

SafeAire® HORIZON® Features



Perimeter exhaust slots improve air flow.



Airfoil front with narrow sidewall provides more interior work area.



Isolated service drop allows vertical fixture mounting for clear work surface.



AutoSash self-adjusting sash provides face protection and energy savings.



Epoxy Resin worksurface has raised edge to contain spills.



Flush airfoil sill provides obstacle-free access to work surface.



Secondary spill containment trough provides extra protection.

OPTIONS



Lattice Rack
Plugged mounting holes in hood interior for easy installation of the optional lattice rack.



Panel End
White polyresin panel with high chemical resistance – specify when total visibility is not required. White polyresin back panel is available on extended lead time.



Epoxy Resin Worksurface Colors
Black is the standard color. Ten optional colors are available.

SafeAire® HORIZON® Product Configurations

Single or Double Faced Assemblies



End View



Front View



End View



Front View

Single Sided Wall Configuration
Back panel is white poly resin. Side and sash panels are 1/4" laminated safety glass.

Double Sided Island Configuration
Back, side and sash panels are 1/4" laminated safety glass.

Multiple Widths

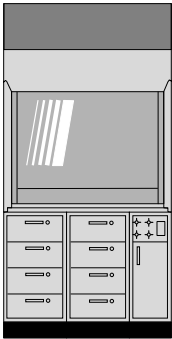

48" Wide

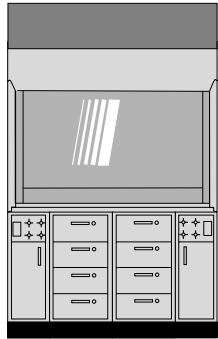

60" Wide

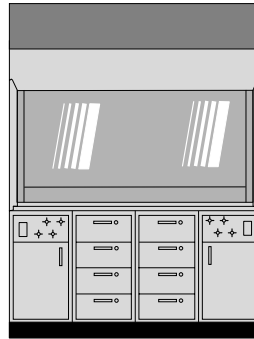

72" Wide

Standard Equipment

Horizon assemblies include a fume hood superstructure, work surface, base cabinets and fillers. Choose from eighteen standard steel colors. Service fixtures, when specified, include remote-control gas, air, vacuum and cold water with a 3" X 6" cupsink. Where services are not ordered, plugged fixture holes are provided for future fixture installation. Services can be ordered for both sides or right side only.

Stand-Alone or Multiple Unit Assembly Components

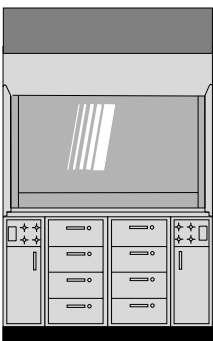

Stand-Alone

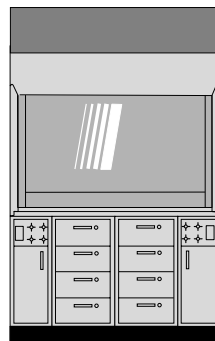

Left End

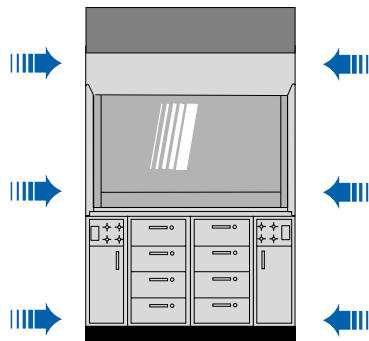

Middle

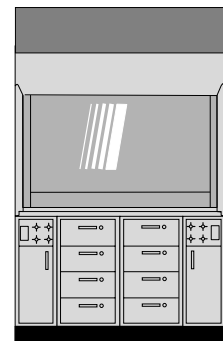

Right End

Multiple unit assembly components provide a common end with a single pane of glass between adjoining units. Eliminating double ends between units reduces the cost of multiple unit assemblies.

Multiple units are configured as follows: A two-unit assembly would consist of a left end and a right end. A three-unit assembly would consist of a left end, a middle and a right end. Add additional middle units for multiple unit assemblies of more than three units.



Fisher Hamilton L.L.C.
1316 18th Street
Two Rivers, WI 54241
Tel: 920-793-1121
www.fisherhamilton.com